

Itasca County Timber Appraisal Report

Appraised By: Carlie Haben Appraisal Date: 03/07/2023	Sale Type: REGULAR AUCTION SALE Auction Date: 12/14/2023	Appraisal Number: 23-05-03 Permit Number: Expiration Date: 03/01/2026 Page: 1 of 3
--	---	---

Legal Description

<u>RE Code</u>	<u>Sec.</u>	<u>Twp.</u>	<u>Rge.</u>	<u>City/Twp</u>	<u>Subd</u>		
61-031-3100	31	61	25	Unorganized	NE SW		
61-031-3300	31	61	25	Unorganized	LOT 4		
61-031-3400	31	61	25	Unorganized	SE SW		
<u>Block 1 Species</u>	<u>Volume</u>	<u>Units</u>	<u>Unit Price</u>	<u>Value</u>	<u>Comments</u>	<u>Bolt %</u>	<u>Bid</u>
Aspen	1,300	Cords	\$24.00	\$31,200.00	5 stick/ 8" avg. DBH/ good - excellent	10	^
Paper Birch	78	Cords	\$9.00	\$702.00	4 stick/ 7" avg. DBH/ fair	5	#
Balsam Fir	38	Cords	\$11.00	\$418.00	3-6 stick/ 9" avg. DBH/ good	25	#
Maple	27	Cords	\$9.00	\$243.00	3-5 stick/ 10" avg. DBH/ fair		#
Spruce	12	Cords	\$18.00	\$216.00			#
Ash	3	Cords	\$8.00	\$24.00			#
Tamarack	2	Cords	\$5.00	\$10.00			#
				\$32,813.00	Subtotal		
Total Cords =	1,460	Total MBF: 0		\$32,813.00	Total		

Bid Symbols: ^ = Bid Species; # = Non-Bid Species; + = Sold Area Estimate; * = Sold Area Estimate & Non-Bid Species
 All species woodsrun unless listed otherwise.

Species Scaled: Ash , Aspen, Balsam Fir, Maple , Paper Birch , Spruce , Tamarack
Species SAE:

Operability: Frozen Winter: 12/1 - 3/1	Soil Type: 620B Cutaway loamy sand. 625 Sandwick loamy fine sand.
Topography: Level to rolling	Cutting Acres: 40.7

All permits must follow Itasca County Forest Management Guidelines and Specifications (can be found at <http://www.co.itasca.mn.us/DocumentCenter/View/567/Forest-Management-Guidelines-and-Specifications>).

Harvest Specifications

Harvest Guidelines
Harvest Type: Aspen Clearcut with reserves. Cut all stems within the harvest area, unless otherwise noted in the "Reserve Guidelines".
Reserve Guidelines
Reserve all non-hazardous snags. Reserve pine, oak, and unmerchantable balsam and maple.
Cutting, Felling, and Skidding
Sale boundaries painted orange. Do not disturb survey markers, including witness trees. See attached map for general locations. Do not damage reserve trees.

Itasca County Timber Appraisal Report

Appraised By: Carlie Haben Appraisal Date: 03/07/2023	Sale Type: REGULAR AUCTION SALE Auction Date: 12/14/2023	Appraisal Number: 23-05-03 Permit Number: Expiration Date: 03/01/2026 Page: 2 of 3
--	---	---

Access

Two possible routes to the permit area. One route is through the Scenic State Park, 2.2 miles to Hwy 7. The other route is 2 miles north across county land to the Bakke Rd.

Snowmobile trail regulations in Itasca County Forest Management Guideline & Specifications apply. A minimum of two inches of compacted snow must remain on the trail as a running surface.

It is the permit holder's responsibility to obtain approval from all affected landowners and/or management agencies before gaining access to the permit area. The permit holder shall pay all access fees and road charges.

Gate must be locked at all times, except on days when 3 or more loads are hauled.

Landings and Access Roads

Location and construction of any new roads/landings must be pre-approved by the sale administrator.

Trails and landings need to be rehabilitated to a satisfactory condition, determined by administering forester, before performance bond is returned.

Timber sale administrator shall be notified at least 3 working days prior to completion of hauling and road work. This provides adequate time for permit area inspection and addressing of permit compliance requirements before hauling and road work equipment is removed.

Site, Soil, and Water Protection

Filter strips require <5% soil disturbance within 50 feet of all wetlands.

Reserve all non-merchantable timber within 15 feet of all wetlands.

Slash Disposal

Slash must be evenly distributed throughout permit area.

Regeneration Plan

Regeneration will be achieved from aspen coppice and from adjacent forested stands, via seed.

Itasca County Timber Appraisal Report

Appraised By: Carlie Haben	Sale Type: REGULAR AUCTION SALE	Appraisal Number: 23-05-03
Appraisal Date: 03/07/2023	Auction Date: 12/14/2023	Permit Number:
		Expiration Date: 03/01/2026
		Page: 3 of 3

Site Map:

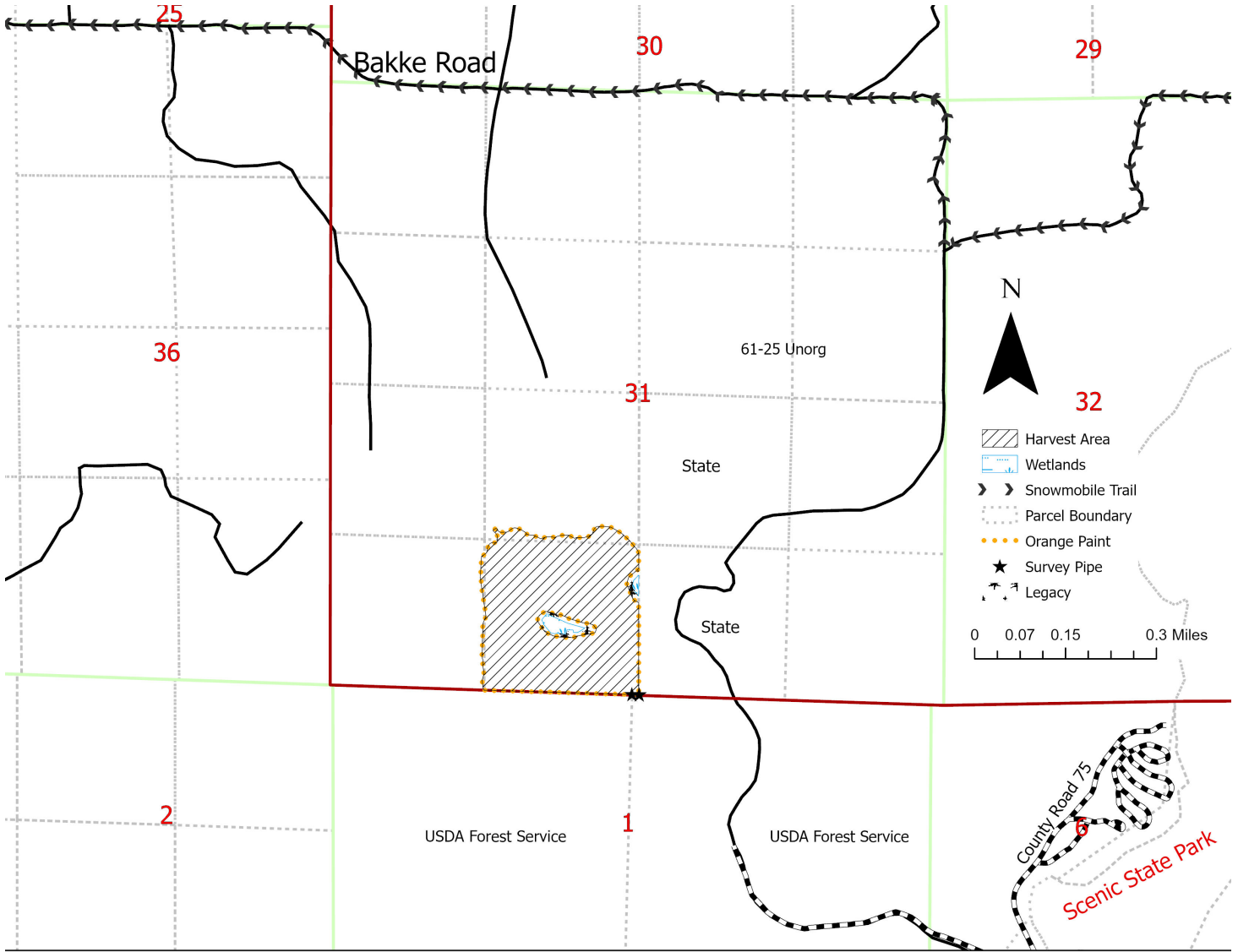

Appraisal examined and approved by _____ Forester _____ Date

Appraisal examined and approved by _____ Land Department _____ Date