

Itasca County Timber Appraisal Report

Appraised By:

Carlie Haben

Appraisal Date:

03/08/2023

Sale Type:

REGULAR AUCTION SALE

Auction Date:

12/11/2024

Appraisal Number: 23-05-04**Permit Number:****Expiration Date:** 03/01/2028**Page:** 1 of 3**Legal Description**

RE Code	Sec.	Twp.	Rge.	City/Twp	Subd
53-034-4400	34	60	23	Unorganized	SE SE
53-035-3300	35	60	23	Unorganized	SW SW
53-035-3400	35	60	23	Unorganized	SE SW
53-035-3100	35	60	23	Unorganized	NE SW
53-035-4000	35	60	23	Unorganized	SE 1/4
53-034-4300	34	60	23	Unorganized	SW SE

Block 1 Species	Volume	Units	Unit Price	Value	Comments	Bolt %	Bid
Ash	594	Cords	\$8.00	\$4,752.00	3-5 stick/ 7-14" DBH/ fair	20	^
Maple	507	Cords	\$8.00	\$4,056.00	3-5 stick/ 6-14" DBH/ fair		^
Aspen	243	Cords	\$23.00	\$5,589.00	3-7 stick/ 8-16" DBH/ fair	20	^
Balsam Fir	188	Cords	\$11.00	\$2,068.00	3-5 stick/ 5-10" DBH/ good	10	#
Paper Birch	115	Cords	\$9.00	\$1,035.00	3-6 stick/ 8-14" DBH/ fair	10	#
Balm	41	Cords	\$15.00	\$615.00	3-5 stick/ 6-10" DBH/ fair		#
Basswood	39	Cords	\$9.00	\$351.00	4-6 stick/ 6-16" DBH/ good	30	#
Spruce	26	Cords	\$17.00	\$442.00	3-7 stick/ 6-12" DBH/ good	40	#
				\$18,908.00	Subtotal		
Total Cords =	1,753		Total MBF: 0	\$18,908.00	Total		

Bid Symbols: ^ = Bid Species; # = Non-Bid Species; + = Sold Area Estimate; * = Sold Area Estimate & Non-Bid Species
All species woodsrun unless listed otherwise.

Species Scaled: Ash , Aspen, Balm , Balsam Fir, Basswood , Maple , Paper Birch , Spruce

Species SAE:

Operability: Frozen Winter: 12/1 - 3/1

Soil Type: 622B Nashwauk fine sandy loam.

Topography: Level to rolling

Cutting Acres: 89.4

All permits must follow Itasca County Forest Management Guidelines and Specifications (can be found at <http://www.co.itasca.mn.us/DocumentCenter/View/567/Forest-Management-Guidelines-and-Specifications>).

Harvest Specifications**Harvest Guidelines**

Harvest Type: Clearcut with reserves.

Harvest all stems within harvest area, unless designated as reserve in "Reserve Guidelines".

Reserve Guidelines

Reserve all non-hazardous snags.

Reserve cedar, pine, yellow birch, Ash under 6 inches Dbh and Balsam fir with 2 or fewer sticks.

Cutting, Felling, and Skidding

Do not disturb survey markers, including witness trees. General locations can be seen on attached map.

Sale boundaries painted orange and natural boundaries.

Do not damage reserve trees.

Itasca County Timber Appraisal Report

Appraised By: Carlie Haben	Sale Type: REGULAR AUCTION SALE	Appraisal Number: 23-05-04
Appraisal Date: 03/08/2023	Auction Date: 12/11/2024	Permit Number:
		Expiration Date: 03/01/2028
		Page: 2 of 3

Access

Snowmobile trail regulations in Itasca County Forest Management Guideline & Specifications apply. A minimum of two inches of compacted snow must remain on the trail as a running surface.
Little Moose Trail- 2.3 miles to Hwy 65.

Landings and Access Roads

Location and construction of any new roads/landings must be pre-approved by the sale administrator.
Trails and landings need to be rehabilitated to a satisfactory condition, determined by administering forester, before performance bond is returned.
Timber sale administrator shall be notified at least 3 working days prior to completion of hauling and road work. This provides adequate time for permit area inspection and addressing of permit compliance requirements before hauling and road work equipment is removed.

Site, Soil, and Water Protection

Filter strips require <5% soil disturbance within 50 feet of all wetlands.

Slash Disposal

Slash must be evenly distributed throughout permit area.

Regeneration Plan

Natural regeneration of current harvest area species is expected to reforest the harvest area.

Itasca County Timber Appraisal Report

Appraised By:

Carlie Haben

Appraisal Date:

03/08/2023

Sale Type:

REGULAR AUCTION SALE

Auction Date:

12/11/2024

Appraisal Number: 23-05-04

Permit Number:

Expiration Date: 03/01/2028

Page: 3 of 3

Site Map:

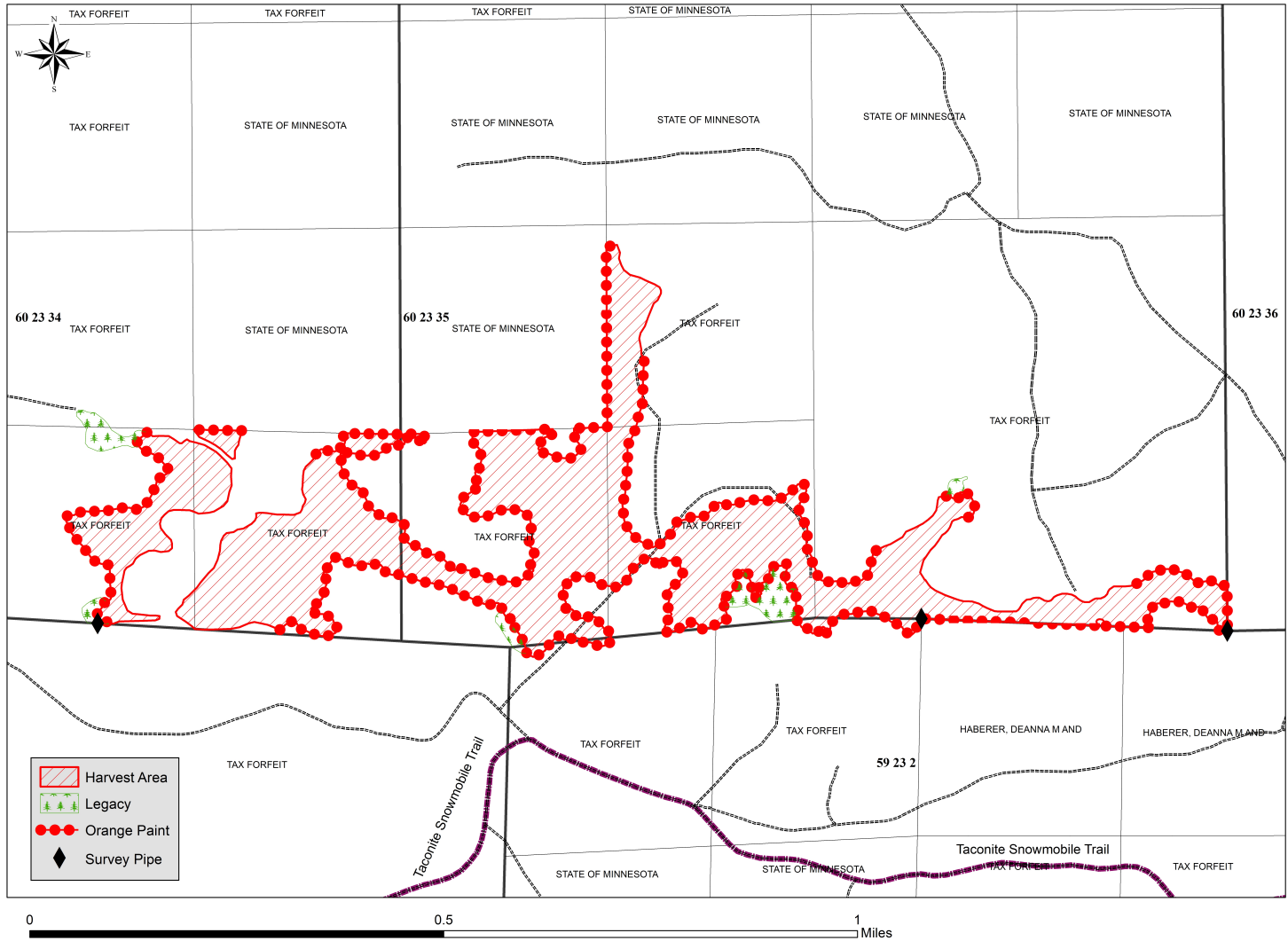

Appraisal examined and approved by

Forester

Date

Appraisal examined and approved by

Land Department

Date