

Itasca County Timber Appraisal Report

Appraised By:

Carlie Haben

Appraisal Date:

12/09/2022

Sale Type:

INTERMEDIATE AUCTION

Auction Date:

12/14/2023

Appraisal Number: 23-07-13**Permit Number:****Expiration Date:** 03/01/2026**Page:** 1 of 3**Legal Description**

RE Code	Sec.	Twp.	Rge.	City/Twp	Subd		
30-108-2000	8	57	23	Nashwauk	NW 1/4		
30-108-1000	8	57	23	Nashwauk	NE 1/4		
Block 1 Species	Volume	Units	Unit Price	Value	Comments	Bolt %	Bid
Aspen	369	Cords	\$24.00	\$8,856.00	4-8 stick, 8-16-inch Dbh, Good quality	20	^
Red Pine	114	Cords	\$45.00	\$5,130.00	3-8 stick, 6-18-inch Dbh, Good quality, 60% saw	20	^
Spruce	33	Cords	\$17.00	\$561.00	4-7 sticks, 6-12-inch Dbh, Good quality, 100% Black spruce	20	#
Ash	21	Cords	\$8.00	\$168.00	2-6 stick, 8-13-inch Dbh, Fair-Good quality	0	#
Jack Pine	16	Cords	\$8.00	\$128.00	7-8 stick, 8-16-inch Dbh, Fair-Good quality	0	#
Balm	9	Cords	\$17.00	\$153.00	5 stick, 8-10-inch Dbh, Fair quality	0	#
				\$14,996.00	Subtotal		
Total Cords =	562		Total MBF: 0	\$14,996.00	Total		

Bid Symbols: ^ = Bid Species; # = Non-Bid Species; + = Sold Area Estimate; * = Sold Area Estimate & Non-Bid Species
All species woodsrn unless listed otherwise.

Species Scaled: Ash , Aspen, Balm , Jack Pine, Red Pine, Spruce

Species SAE:

Operability: Winter Frozen: 12/1 - 3/1

Soil Type: Nashwauk fine sand loam, Menahga & Graycalm Soils, Mooselake & Lupton mucky peats

Topography: Rolling

Cutting Acres: 13.0

All permits must follow Itasca County Forest Management Guidelines and Specifications (can be found at <http://www.co.itasca.mn.us/DocumentCenter/View/567/Forest-Management-Guidelines-and-Specifications>).

Harvest Specifications

Harvest Guidelines
Harvest Type: Clearcut w/reserves
Harvest all aspen, balm, red pine, jack pine, black spruce and ash greater than 8 inches Dbh.

Reserve Guidelines
Reserve all maple, basswood, oak, birch, balsam fir and white pine.
Reserve all non-hazardous snags.
Trees marked with "R" are to be reserved for wildlife.

Cutting, Felling, and Skidding
Do not damage reserve trees.
Do not fell timber into wetlands or across sale boundaries.
Sale boundaries are painted using orange paint. Natural boundaries, without paint, are also used for this permit.

Access
Access is along public roadways.

Itasca County forestlands are Forest Stewardship Council (FSC) Certified by NEPCo, NC-FM/COC-001709; FSC 100%

Itasca County Timber Appraisal Report

Appraised By: Carlie Haben	Sale Type: INTERMEDIATE AUCTION	Appraisal Number: 23-07-13
Appraisal Date: 12/09/2022	Auction Date: 12/14/2023	Permit Number:
		Expiration Date: 03/01/2026
		Page: 2 of 3

Landings and Access Roads

Location and construction of any new roads/landings must be pre-approved by the sale administrator.

Trails and landings need to be rehabilitated to a satisfactory condition, determined by administering forester, before performance bond is returned.

Berm(s) must be installed after sale is completed.

Timber sale administrator shall be notified at least 3 working days prior to completion of hauling and road work. This provides adequate time for permit area inspection and addressing of permit compliance requirements before hauling and road work equipment is removed.

Site, Soil, and Water Protection

Filter strips require <5% soil disturbance within 50 feet of all wetlands.

Roads and skid trails must be stabilized. This may involve installing water bars, strike outs, and/or mulching and seeding.

Slash Disposal

Slash must be evenly distributed throughout permit area.

Regeneration Plan

Regeneration is to be accomplished by way of aspen coppice and by seed from adjacent stand/reserve species.

Itasca County Timber Appraisal Report

Appraised By:

Carlie Haben

Appraisal Date:

12/09/2022

Sale Type:

INTERMEDIATE AUCTION

Auction Date:

12/14/2023

Appraisal Number: 23-07-13

Permit Number:
Expiration Date: 03/01/2026

Page: 3 of 3

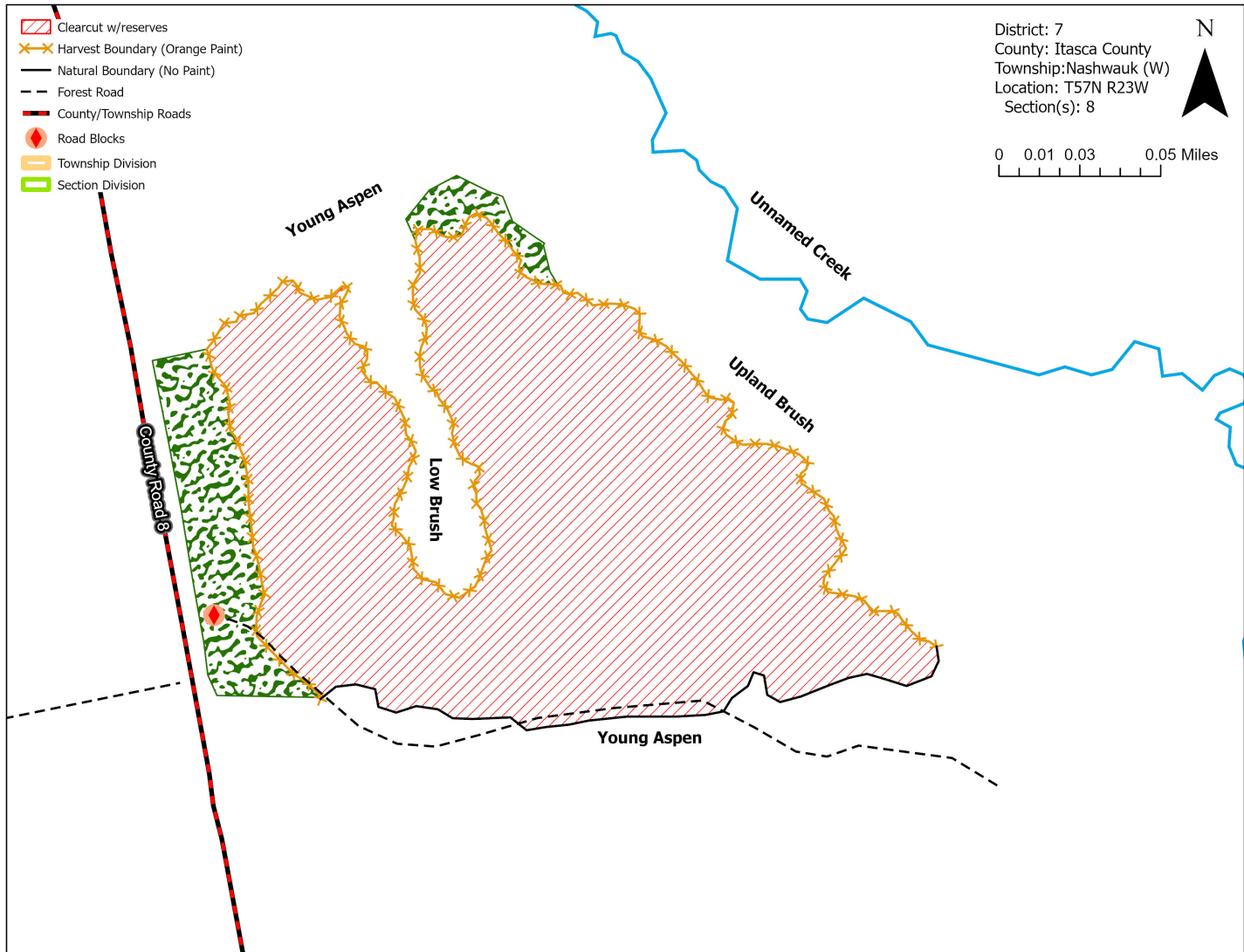
Site Map:

Appraisal examined and approved by

Forester

Date

Appraisal examined and approved by

Land Department

Date